



19 Kent Street Epping, NSW

5

3

2

Full Brick Charming Family Home in Central Epping

Discover the timeless elegance of this beautifully updated Federation gem, located in the heart of Epping. This stunning Federation residence captures the essence of a bygone era with its intricate leadlight windows, high ornate ceilings, and original fireplace. The welcoming foyer opens into a series of light-filled living spaces, perfect for entertaining or simply unwinding with family. The kitchen effortlessly blends classic charm with modern functionality, boasting quality appliances and ample storage space.

Price:

Auction guide \$2,300,000



Juliet (Jiangmin) Chen

0408 997 997

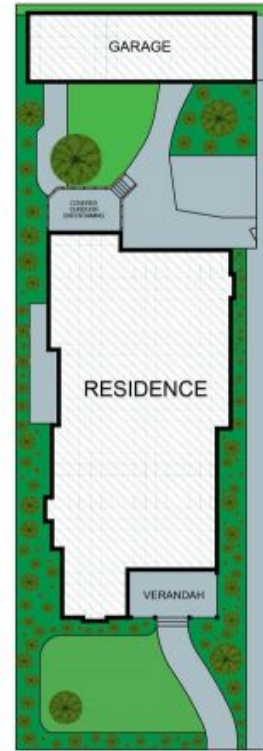
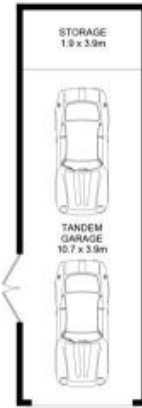

SITE PLAN
(NOT TO SCALE)

The floor plan is not to scale; measurements are indicative and in metres. Exterior elements are not in position. Plans should not be relied on. Interested parties should make and rely on their own enquiries.

19 Kent Street, Epping

Internal Area Approx. - 193 sqm
External Area Approx. - 24 sqm
Land Area Approx. - 0 sqm

