

1/141 Carlingford Road Epping, NSW 3  2  2 

Generous Townhouse Walk to Epping West Public School

Nestled in the heart of Epping, this exquisite triple-level full brick townhouse offers the pinnacle of modern living in great location. It is zoned for Epping West Public School, Cheltenham Girls High School, and Carlingford High School, ensuring a quality education for your children.

Price: Contact Agent
Council Rates: \$325.80 p/q
Water Rates: \$218.80 p/q
Strata Rates: \$1,560.00 p/q



Juliet (Jiangmin) Chen
 0408 997 997



Team Juliet
 0466 907 733

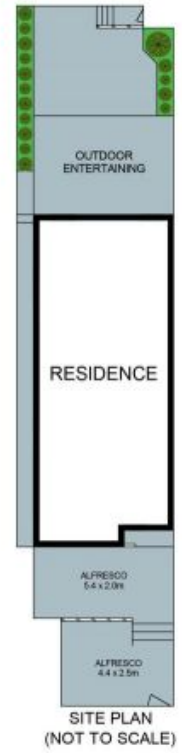
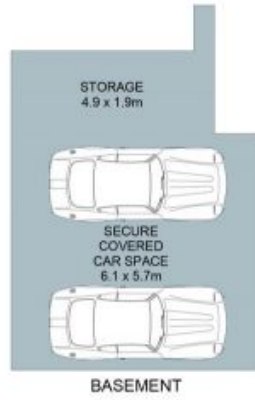
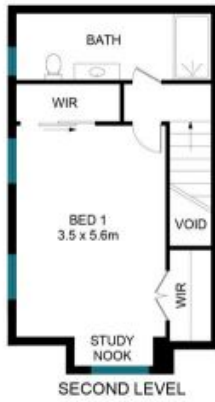

The floor plan is not to scale; measurements are indicative and in metres. Exterior elements are not in position. Plans should not be relied on. Interested parties should make and rely on their own enquiries.

1/141 Carlingford Road, Epping

STONE