

13 Linga Longa Road Yarramalong, NSW



### Village Charm, Family Warmth

Located in the heart of Yarramalong Village, this charming home captures the warmth and character of country living while offering all the modern comforts a family could need. Set on a generous quarter acre block, the home features four bedrooms and two bathrooms, including a master suite complete with a walk-in robe and ensuite. The spacious kitchen is fitted with a gas cooktop and dishwasher, flowing effortlessly into the open-plan living and dining areas designed for everyday family life and easy entertaining.

Price:

New To Market



**Scott Wall**

0413 965 616



**Kaela Wall**

0434 726 944

13 Linga Longa Road,  
YARRAMALONG

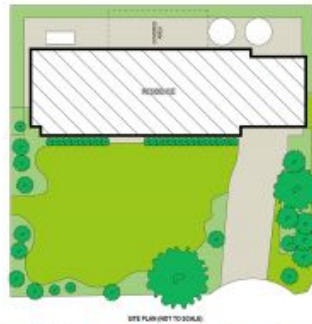

INTERNAL: 144sqm  
EXTERNAL: 197sqm

PLEASE NOTE: These Floorplan + Site Plans have been generated for marketing purposes and are to be used as a guide only. While all care is taken, no guarantee can be given in respect of accuracy, sizes and dimensions are approximate, actual may vary.

