



22A Cardinal Avenue Beecroft, NSW

4 3 2

A masterfully modernized performer in the best parkside location

A discreet bushland position distanced from street view ensures an unforgettable environment in this exquisite family home. It sets exceptional standards for living and entertaining through a host of brand new upgrades, executed to achieve stylish finesse and maximising the home's divine rear aspect of Fearnley Park. It's a home of distinct appeal moments from Beecroft Station and village delights.

Price: \$1,400 per week

Bond: \$5,600

Available Date: 14/11/2025



Ashleigh Gray

02 8893 2222



Eliza Zammit

02 8893 2220

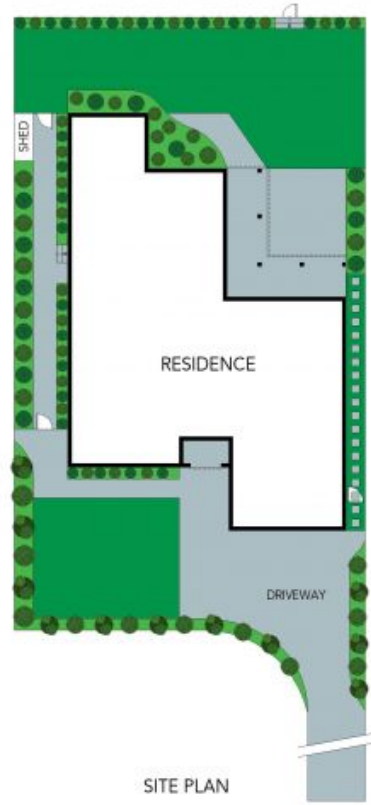

The floor plan is not to scale; measurements are indicative and in metres. Exterior elements are not in position. Plans should not be relied on. Interested parties should make and rely on their own enquiries.

22A Cardinal Avenue, Beecroft

