



28 Wiseman Road CASTLE HILL, NSW

4 

4 

2 

Single Level Living!

Lifestyle: Situated in a blissfully suburban setting framed by picturesque garden beds, this inviting family home delivers versatile functionality with traditional details. Spacious and full of warmth, this tastefully styled property presents an exceptional opportunity in an increasingly sought after location. You'll enjoy a range of quality schools and shopping centres within close proximity including Castle Towers as well as benefit from a bus stop on the corner and the future Castle Hill train station nearby.

Price: \$1,250,000

Stone Beecroft | Castle

02 8866 1500

Hill | Epping

28 Wiseman Road, Castle Hill

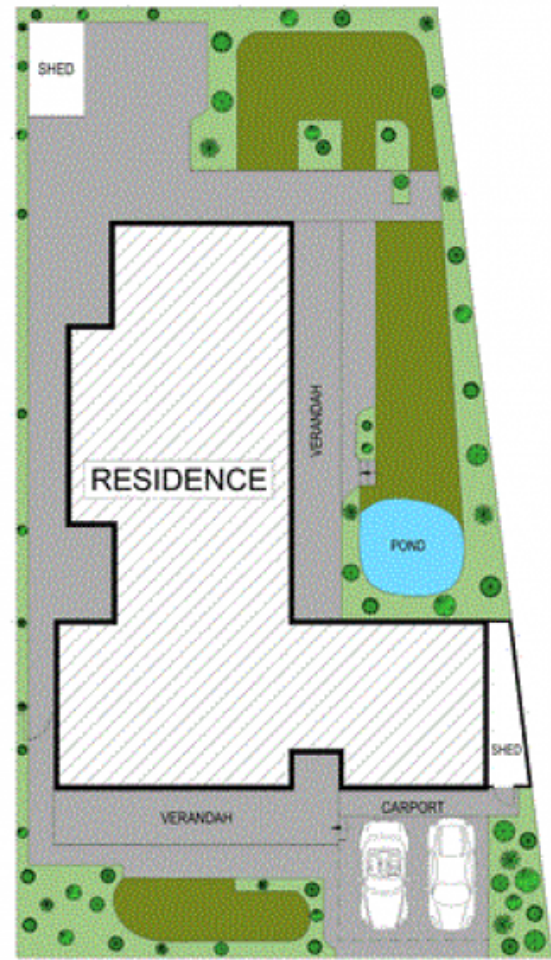

Site Plan

DISCLAIMER
DIMENSIONS ARE APPROXIMATE AND SHOULD ONLY BE USED AS A GUIDE.
THEY ARE NOT TO SCALE AND NO LIABILITY WILL BE ACCEPTED.

