



7 Uralba Place Oatlands, NSW

3

2

2

Pretty as a picture

Idyllically-set and character-filled, this gorgeous home is inviting you to make it your own. Ideal for a couple or family wanting up-market entry into this prestigious and sought after pocket of Oatlands. Stylishly renovated single level offers comfort, security and convenience all nestled in a quiet, leafy cul de sac, walking distance to just about everything. You won't even need the golf buggy here!

Price:

Contact Agent



Viviane Mylott

0438 983 615



Jane Booty

0412 207 452



LOWER GROUND LEVEL



GROUND LEVEL



Produced by DIAKRIT

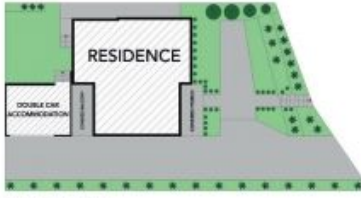

SITE PLAN



LOWER GROUND LEVEL



GROUND LEVEL

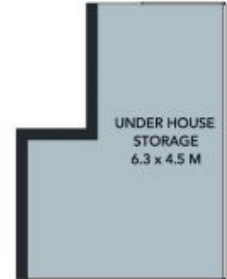

(NOT IN POSITION)



TOTAL LAND AREA : 454 SQM
 TOTAL LIVING AREA : 135 SQM The site plan and floor plan are not to scale, measurements are indicative and in metres. Bushes and trees are placed for illustration purposes. Plans should not be relied on. Interested parties should make and rely on their own enquiries. Produced by DIAKRIT