

STONE



18/86 Wrights Road Kellyville, NSW



That alpine feel

Doesn't get any better than this! Nestled within an Alpine inspired complex which rarely become available. With recent updating this now pristine multi-level townhouse is ready to move into and offers an expansive, low maintenance lifestyle for today's busy way of life.

Price: \$1,225,000

Council Rates: \$316.00 p/q

Water Rates: \$186.77 p/q

Strata Rates: \$581.10 p/q



Viviane Mylott

0438 983 615



Jane Booty

0412 207 452



Basement



First Floor



Ground Floor



The site plan and floor plan are not to scale; measurements are indicative and in metres. Bushes and trees are placed for illustration purposes. Plans should not be relied on. Interested parties should make and rely on their own enquiries. All other information provided has been collected from reliable sources but cannot be guaranteed for accuracy.

18/86 Wrights Road
Kellyville

STONE

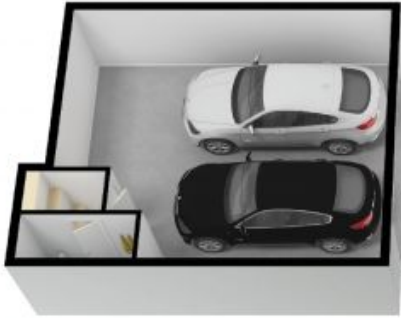

Basement



First Floor



Ground Floor



The floor plan is not to scale; measurements are indicative and in metres. All features included in this 3D plan are for inspiration purposes only. This is not an exact replica of the property or the position of exterior elements. Plans should not be relied on. Interested parties should make and rely on their own enquiries.