



4/37 Copeland Road Beecroft, NSW



Single level desirability with rare scale and address

The peace and privacy of a discreet end-of-row position distinguishes this pristine villa, quietly tucked to the rear of a tightly-held over 55's enclave of just four. With three impressive living/ dining domains, 2.7M high ceilings and every advantage of single level ease spanning a vast 245sqm layout, it offers a commitment to lifestyle and leisure only a stone's throw from Pennant Hills Golf Club and local buses, with Beecroft village amenities a few minutes down the road.

Price: Sold by Graham Black
Council Rates: \$370.40 p/q
Water Rates: \$150.99 p/q
Strata Rates: \$489.00 p/q



Graham Black

0400 381 217

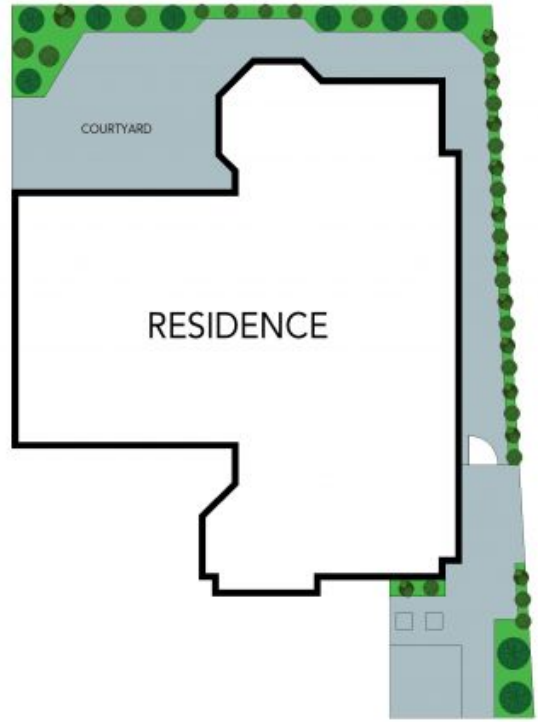

SITE PLAN

The floor plan is not to scale; measurements are indicative and in metres. Exterior elements are not in position. Plans should not be relied on. Interested parties should make and rely on their own enquiries.



4/37 Copeland Road, Beecroft

