

47 Annabelle Crescent Kellyville, NSW

2 1 1

2-Bedroom Granny Flat with Private Entry & Driveway Parking with its own address in Kellyville

Step into your modern sanctuary nestled in the heart of Kellyville! This freshly built 2-bedroom granny flat promises unparalleled comfort and convenience, complete with its own private entrance and dedicated parking spot.

Price: \$590 Per Week
Bond: \$2,360
Available Date: 28/03/2024

Stone Beecroft | Castle Hill | Epping
 02 8866 1500

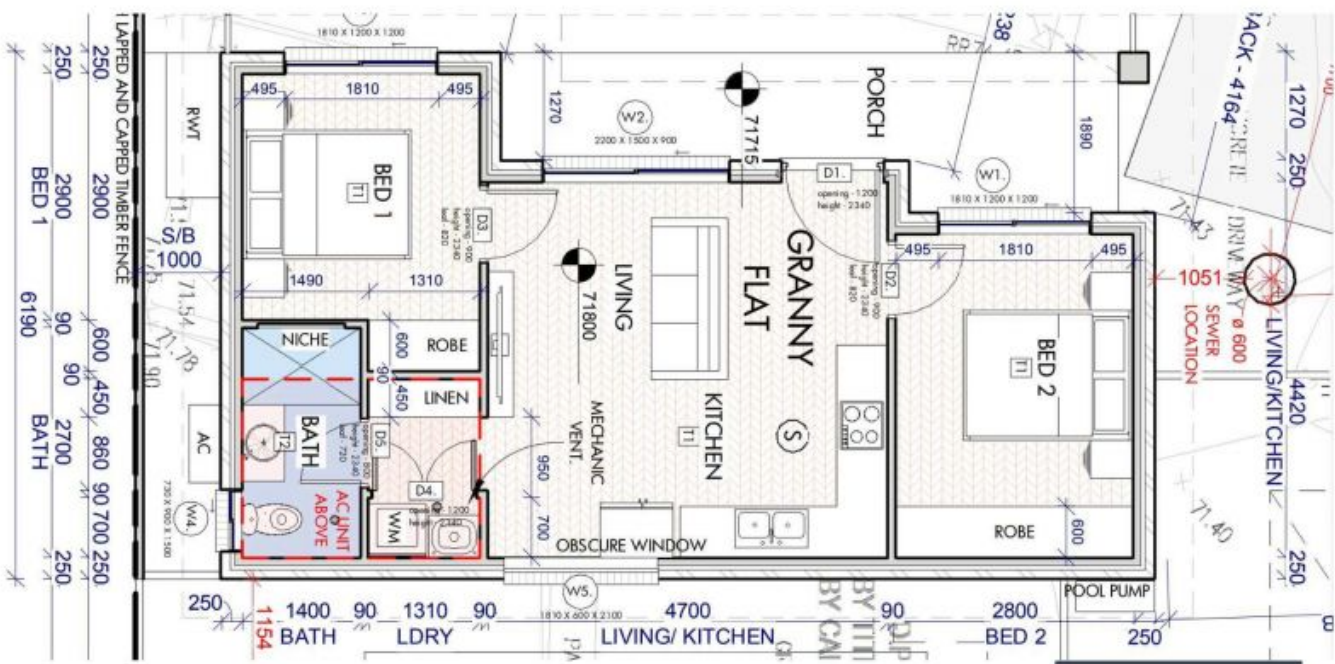

STONE