



2/22 May Street Eastwood, NSW



Peaceful retreat in the heart of Eastwood

Nestled quietly at the rear of the boutique complex, this elevated and spacious one-bedroom full-brick unit delivers a coveted walk-to-everything lifestyle, just moments from Eastwood station and its vibrant retail and dining hub. Boasting the natural allure of a sunlit north-facing aspect, it's a rare lock-and-leave opportunity offering effortless living, ideal for first-home buyers, downsizers or investors.

Price: Contact Agent | Vincent Goh
Council Rates: \$350.60 p/q
Water Rates: \$179.90 p/q
Strata Rates: \$969.50 p/q



Vincent Goh

0412 316 797

2/22 May Street
Eastwood

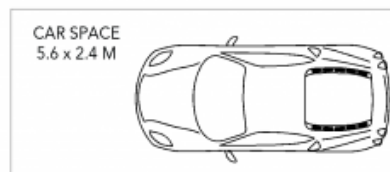
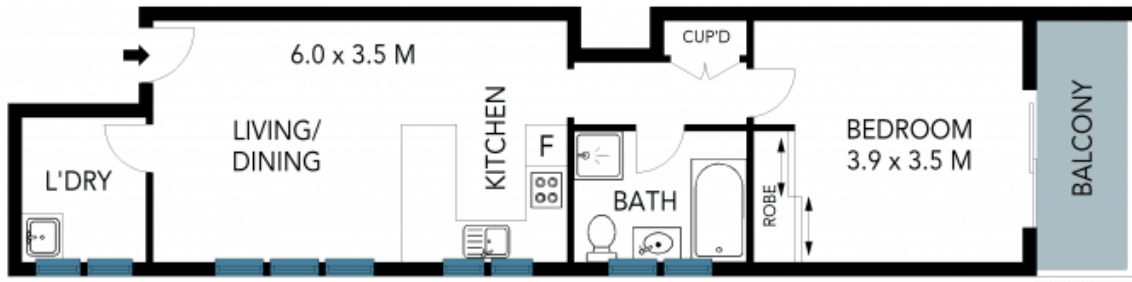

The site plan and floor plan are not to scale; measurements are indicative and in metres. Bushes and trees are placed for illustration purposes. Plans should not be relied on. Interested parties should make and rely on their own enquiries. All other information provided has been collected from reliable sources but cannot be guaranteed for accuracy.