



140 Ray Road Epping, NSW



Blend of Charm, Modern and Comfortable Family Home

Step into the charm of a period-style home with the perfect mix of elegance and modern living. Just 16 years young, this beautifully appointed residence is set on the high side of the street with an almost level block 831.1sqm and 17.1m frontage, offering a north-to-rear aspect, ensuring an abundance of natural light throughout.

Designed with generous proportions, it offers a seamless flow between formal and informal living spaces, with an easy transition to the outdoor entertaining deck and tranquil level yard ? a peaceful private retreat for family living.

Key Features:

- Four generous bedrooms ? Spacious main with ensuite and walk-in robe.
- Stunning wrap-around veranda and Ironbark timber flooring.
- Soaring high ceilings, lead-light windows, and French doors throughout.
- Impressive gas kitchen with stone benches overlooks the yard.
- Formal lounge and dining, plus a rear family room flowing effortlessly to outdoor living.
- Main bathroom featuring a classic clawfoot bath, plus a third WC.
- Zoned ducted air conditioning and security alarm system for peace of mind.

Price:

Contact Agent



Juliet (Jiangmin) Chen

0408 997 997



Team Juliet

0466 907 733

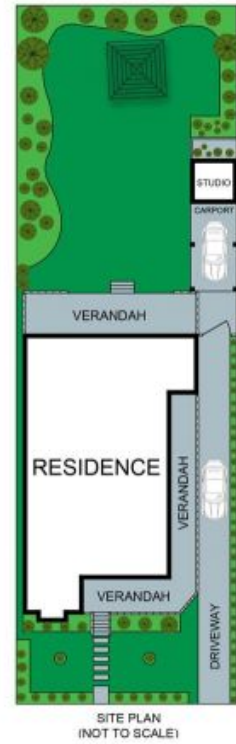
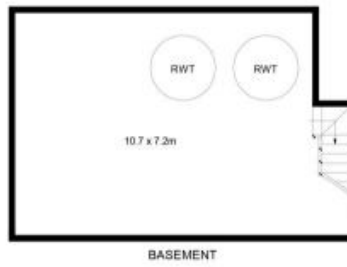

The floor plan is not to scale; measurements are indicative and in metres. Exterior elements are not in position. Plans should not be relied on. Interested parties should make and rely on their own enquiries.

140 Ray Road, Epping

