



59 Hyde Avenue Glenhaven, NSW



### Classic elegance

Generously proportioned townhouse situated within the 'Grove Estate' a sought-after pocket of Glenhaven holding a commanding position on the high side of this leafy street, a rare offering as these townhouses are tightly held and rarely trade. You will be impressed with the size, inclusions, position as well as the recent updates, just move straight in and enjoy.

**Price:** Contact Agent  
**Council Rates:** \$282.00 p/q  
**Water Rates:** \$172.79 p/q  
**Strata Rates:** \$1,223.69 p/q



**Jane Booty**

0412 207 452



**Viviane Mylott**

0438 983 615

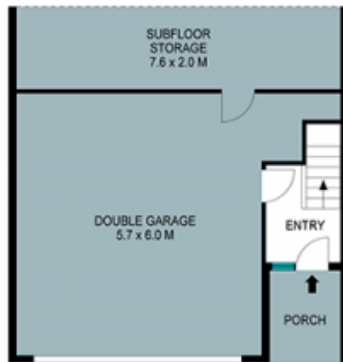

Ground Floor

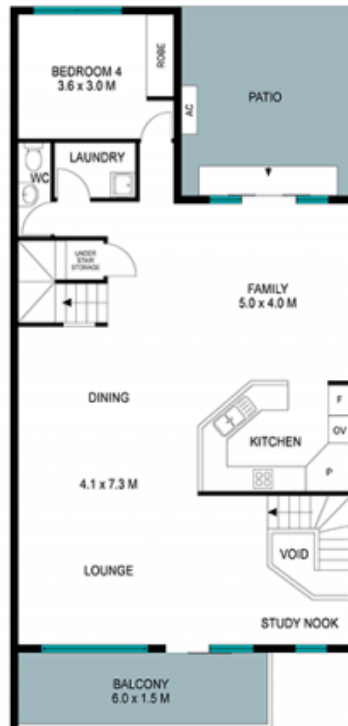

First Floor



Second Floor



The site plan and floor plan are not to scale; measurements are indicative and in metres. Bushes and trees are placed for illustration purposes. Plans should not be relied on. Interested parties should make and rely on their own enquiries. All other information provided has been collected from reliable sources but cannot be guaranteed for accuracy.