



405/118 Old Canterbury Road Lewisham, NSW 2 2

Modern north-facing apartment of prime convenience

Embracing a bright northerly aspect, this modern fourth-floor apartment provides a convenient lifestyle retreat or a smart addition to any investor's portfolio. It showcases a well-designed floorplan while promising minimal upkeep and exceptional convenience. It's a short stroll from Lewisham's light rail and train station, with Anytime Fitness below and vibrant shopping villages also nearby.

Price: \$790,000
Council Rates: \$390.00 p/q
Water Rates: \$179.94 p/q
Strata Rates: \$2,153.98 p/q



Joseph Tropiano
0401 002 211



Irma Rinaudo
0426 240 502

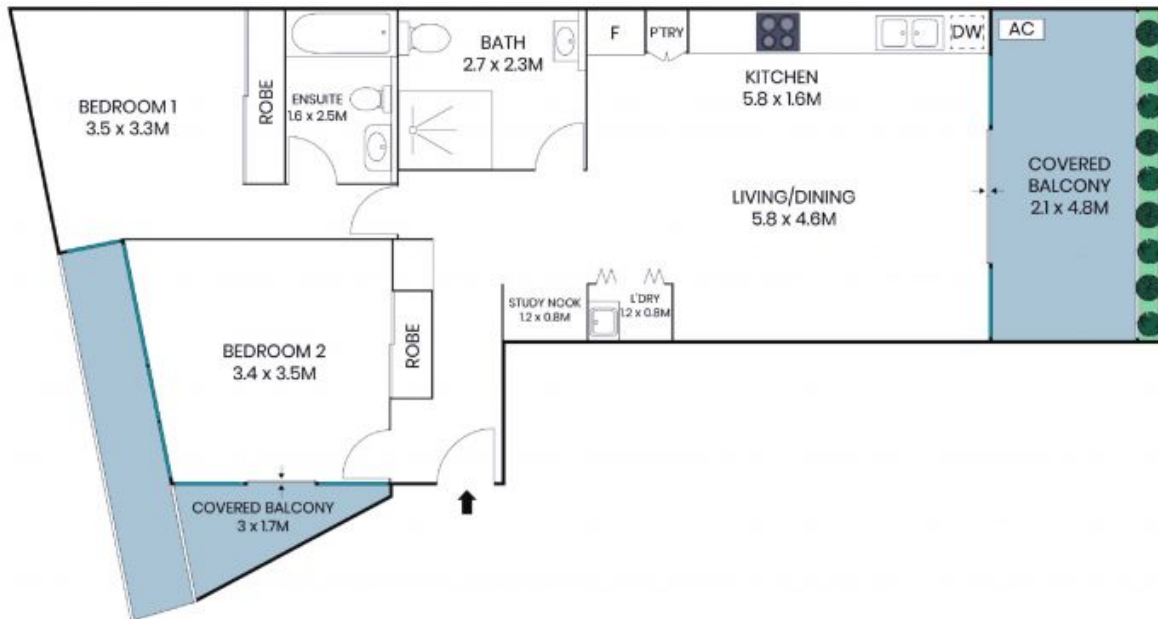

LEVEL FOUR



The site plan and floor plan are not to scale; measurements are indicative and in metres. Bushes and trees are placed for illustration purposes. Plans should not be relied on. Interested parties should make and rely on their own enquiries. All other information provided has been collected from reliable sources but cannot be guaranteed for accuracy.