



110 Mapleton Avenue Harrison, ACT

3 2 1

Modern Lifestyle Home In Prime Location - Low Strata

Perfectly positioned in the heart of Harrison, 110 Mapleton Avenue presents a contemporary dual-level townhouse within an exclusive block of eight, offering low strata and a seamless modern lifestyle. The layout is intelligently designed to maximise space, comfort, and practicality, supported by quality finishes throughout. This is an ideal opportunity for professionals, small families, or investors seeking a low-maintenance residence in a highly desirable location.

Price: SOLD - \$745,000



Jess Smith

0410 125 475



Alex Ogbonna

0423 535 024

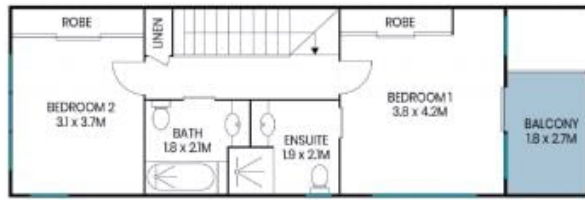

First Floor

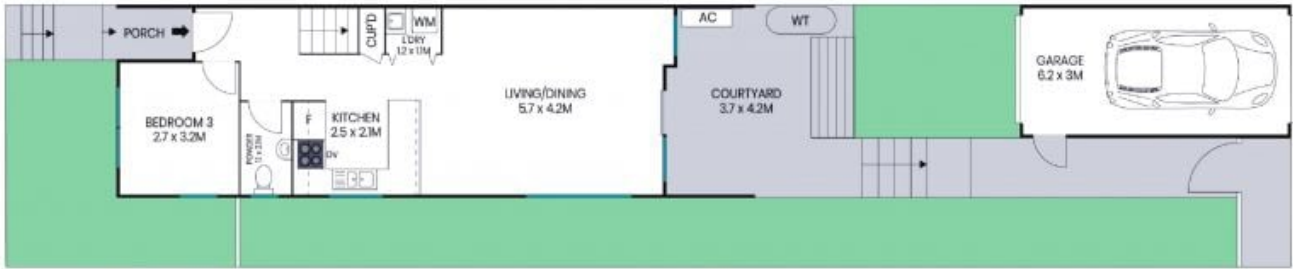

Ground Floor



The site plan and floor plan are not to scale; measurements are indicative and in metres. Bushes and trees are placed for illustration purposes. Plans should not be relied on. Interested parties should make and rely on their own enquiries. All other information provided has been collected from reliable sources but cannot be guaranteed for accuracy.

110 Mapleton Avenue
Harrison



Ground Floor



First Floor



The floor plan is not to scale; measurements are indicative and in metres. All features included in this 3D plan are for inspiration purposes only. This is not an exact replica of the property or the position of exterior elements. Plans should not be relied on. Interested parties should make and rely on their own enquiries.