



3/35 East Esplanade Manly, NSW

2 1 2

Harbourfront apartment with postcard-perfect views

Positioned directly opposite Manly Cove Beach with dreamy views reaching down the harbour to The Eastern Suburbs, this bright and spacious security apartment is pure harbourfront bliss. Move straight in and live it up just footsteps from beaches, Manly Wharf and a smorgasbord of world-class bars, brasseries and restaurants.

Price: Leased
Available Date: 22/11/2025



Anthony Zakos

0419 503 000

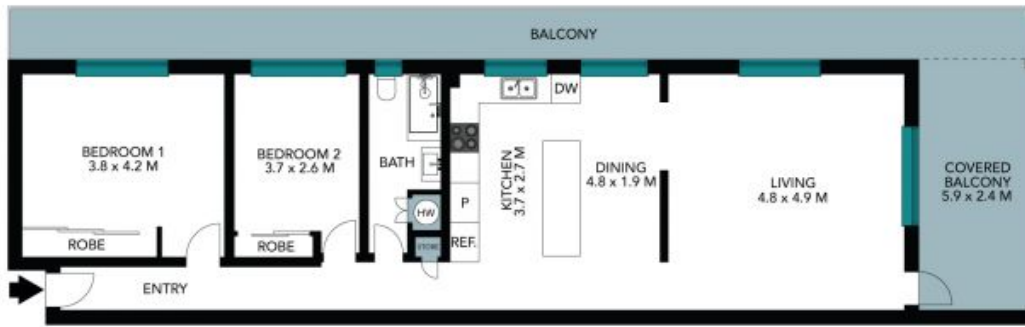

The floor plan is not to scale, measurements are indicative and in metres. Certain elements are not in position. Plans should not be relied on. Interested parties should make and rely on their own enquiries. All other information provided has been collected from reliable sources but cannot be guaranteed for accuracy.

3/35 East Esplanade
Manly

STONE



The floor plan is not to scale; measurements are indicative and in metres. All features included in this 3D plan are for inspiration purposes only. This is not an exact replica of the property or the position of exterior elements. Plans should not be relied on. Interested parties should make and rely on their own enquiries.