



10/3 Elvire Place Palmerston, ACT 3 2 2

### Move-In Ready Home in the Heart of Palmerston

From the moment you enter, it's clear this home has been carefully updated and is ready to be enjoyed immediately, offering stylish, low-maintenance living with nothing left to do.

**Price:** \$663,100



**Alex Ford**

0487 382 549

10/3 Elvire Place  
Palmerston

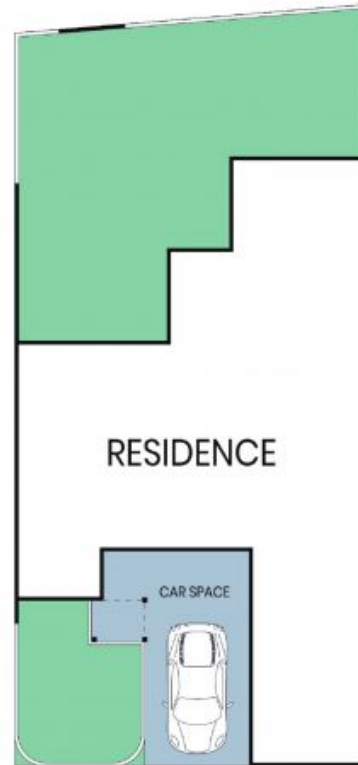
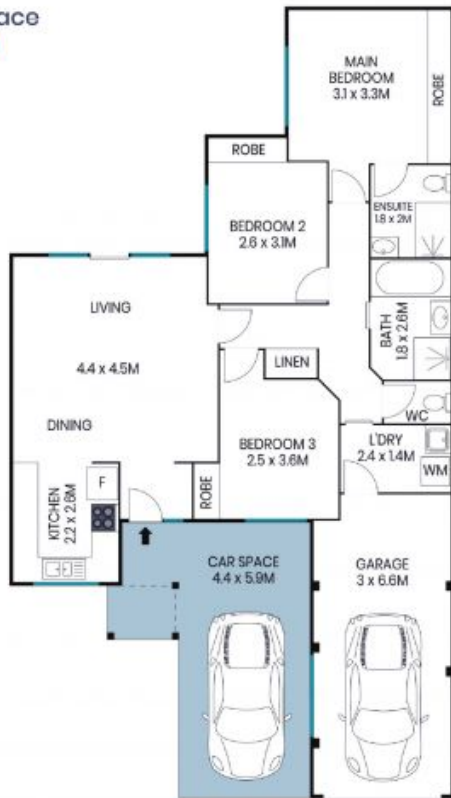

Site Plan



The site plan and floor plan are not to scale; measurements are indicative and in metres. Bushes and trees are placed for illustration purposes. Plans should not be relied on. Interested parties should make and rely on their own enquiries. All other information provided has been collected from reliable sources but cannot be guaranteed for accuracy.

10/3 Elvire Place  
Palmerston



The floor plan is not to scale; measurements are indicative and in metres. All features included in this 3D plan are for inspiration purposes only. This is not an exact replica of the property or the position of exterior elements. Plans should not be relied on. Interested parties should make and rely on their own enquiries.