

52-54 Murray Park Road Figtree, NSW



SOLD BY STONE REAL ESTATE | NEIL WEBSTER & YENSON MUI

Price:

Contact Agent

Private sanctuary set on huge bushland parcel



Neil Webster

0439 028 748



Yenson Mui

0421 882 541

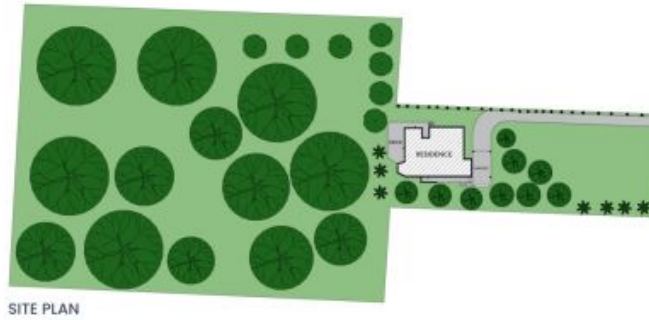

The site plan and floor plan are not to scale. Measurements are indicative and in metres. Bushes and trees are placed for illustration purposes. Plans should not be relied on. Interested parties should check and rely on their own enquiries. All other information provided has been collected from reliable sources but cannot be guaranteed for accuracy.

52-54 Murray Park Road
Figtree



LOWER GROUND



GROUND FLOOR



The floor plan is not to scale; measurements are indicative and in metres. All features included in this 3D plan are for inspiration purposes only. This is not an exact replica of the property or the position of exterior elements. Plans should not be relied on. Interested parties should make and rely on their own enquiries.