



29A Somerville Street Arncliffe, NSW

5

4

2

Brand-New Contemporary Duplex with Courtyard & Alfresco Entertaining

Step into luxury with this stylish five-bedroom home, offering exceptional space, flexibility and refined modern living in a highly convenient Arncliffe location. Designed to suit families and professionals alike, the residence showcases seamless indoor-outdoor flow and multiple living zones ideal for both entertaining and everyday comfort.

Price:

SOLD BY SAM ABBAS | \$2,400,000



Sam Abbas

0406 750 075



EJ Joseph

0432 969 029

29A Somerville Street
Arncliffe

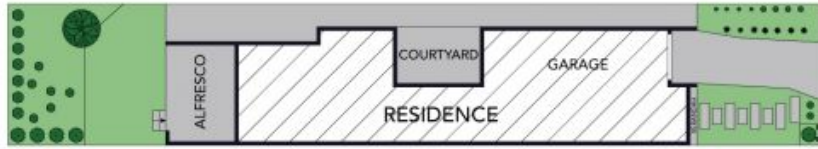

Site Plan

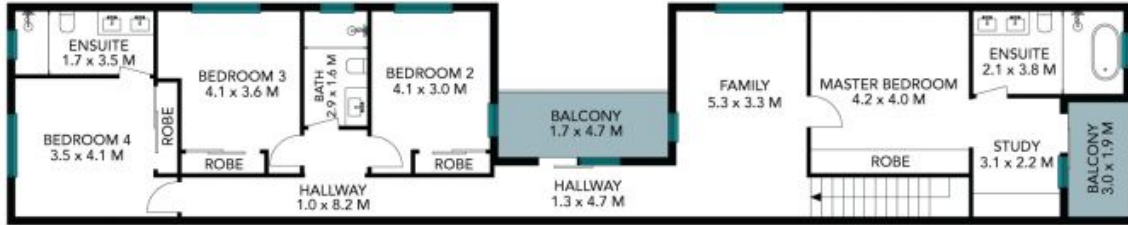

First Floor

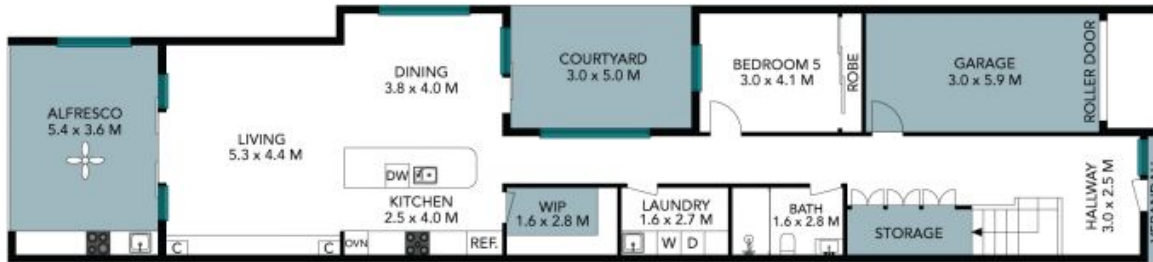

Ground Floor



The site plan and floor plan are not to scale; measurements are indicative and in metres. Bushes and trees are placed for illustration purposes. Plans should not be relied on. Interested parties should make and rely on their own enquiries. All other information provided has been collected from reliable sources but cannot be guaranteed for accuracy.

29A Somerville Street
Arncliffe



First Floor



Ground Floor



The floor plan is not to scale; measurements are indicative and in metres. All features included in this 3D plan are for inspiration purposes only. This is not an exact replica of the property or the position of exterior elements. Plans should not be relied on. Interested parties should make and rely on their own enquiries.