



1780 Dooralong Road Lemon Tree, NSW



A Secluded Estate at the End of Dooralong Valley

Tucked away at the very end of the Dooralong Valley at Lemon Tree within an exclusive and private estate, this elevated dual-occupancy holding spans approximately 36 acres and delivers a rare combination of architectural elegance, rural charm and exceptional lifestyle versatility. Backing directly onto state forest and surrounded by nature, the sense of privacy and seclusion here is truly unmatched, all while being approximately one hour from Hornsby, offering a rare balance of seclusion and city accessibility.

Inspect: Saturday, 23rd May 2026 12:30 - 1:15

Price: New To Market



Scott Wall

0413 965 616



Michelle Booth

0416 856 697

1780 Dooralong Road,
Lemon Tree

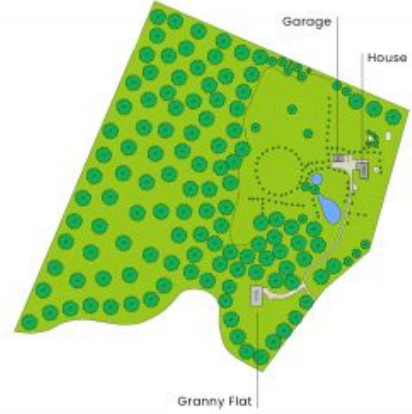
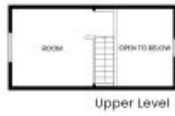
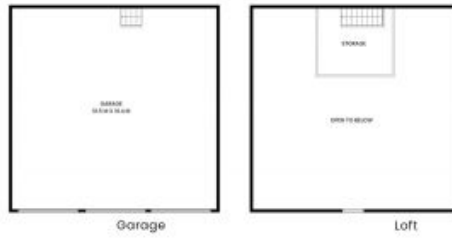

INTERNAL: 249sqm
EXTERNAL: 322sqm

PLEASE NOTE: These Floorplan + Site Plans have been generated for marketing purposes and are to be used as a guide only. While all care is taken, no guarantee can be given in respect of accuracy, sizes and dimensions are approximate, actual may vary.

