



6/9-15 Kings Avenue Roseville, NSW

3

2

2

Exceptional sanctuary

Set against a lush, private green backdrop, this breathtaking and tranquil north-facing ground floor apartment offers an exceptional sense of space, privacy and effortless living. Filled with natural light and leafy outlooks, it is a modern sanctuary perfectly suited to downsizers seeking ease without compromise or young professionals craving a peaceful retreat close to transport and village life.

Designed for seamless indoor?outdoor living, the apartment features a private balcony for entertaining and a private courtyard off the master bedroom, creating serene, private spaces throughout the home.

- Bright ground floor corner position in a boutique building with a highly regarded strata

- Spacious open plan living and dining with solid oak floorboards
- Bi-fold doors opening from living to a private balcony with lush outlook
- Induction cooktop with large bench and breakfast bar, plus premium Miele appliances
- Three generous bedrooms with built-in wardrobes and wool carpet
- Master bedroom with private ensuite and exclusive courtyard

Inspect: Saturday, 16th May 2026 12:15 - 12:45
Saturday, 23rd May 2026 12:15 - 12:45

Price: For Sale - \$2,490,000



Jill Henry

0416 493 555



Sahil Kotian

0434 172 588

6/9-15 Kings Avenue
Roseville

STONE

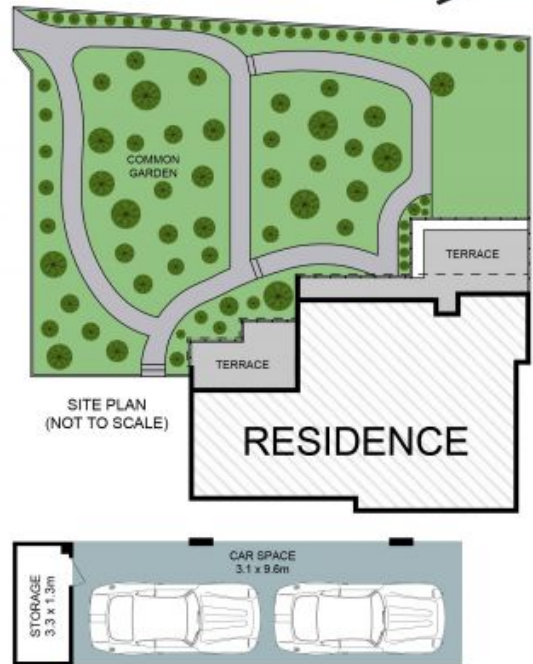

The site plan and floor plan are not to scale; measurements are indicative and in metres. Bushes and trees are placed for illustration purposes. Plans should not be relied on. Interested parties should make and rely on their own enquiries. All other information provided has been collected from reliable sources but cannot be guaranteed for accuracy.