

29 Timbertop Mead Burleigh Heads, QLD



Prestige Burleigh Pocket - Land in Quiet Cul-de-Sac

A rare chance to secure a 504 m² fully serviced block in one of Burleigh's most tightly held pockets. This premium site combines lifestyle and location at its absolute best.

Price:

Motivated Sellers - Contact Agent!



Scott Kelly

0417 466 409



Morgan De Souza

0407 551 437

SITE PLAN LEGEND

1. Driveway Parking
2. Entry Terrace
3. Patio
4. Entertaining Terrace
5. Covered Terrace
6. Entry Deck to Studio

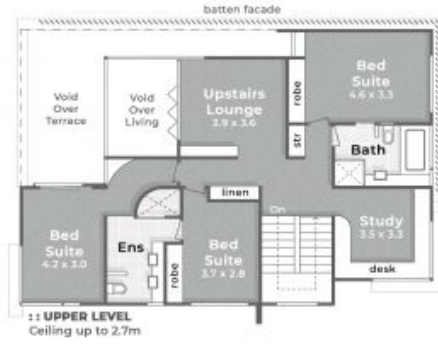

Tracy McCarthy 0425 879 441
Scott Kelly 0417 466 409

29 Timbertop Mead
BURLEIGH HEADS

Internal 372m² | Balcony, Deck, Patio & Terraces 111m² | **Total 483m²**

- 504m²
- 5 Bed + Office + Study
- 4 Bath + Powder
- 3 Car + Off-Street

DISCLAIMER: This is not a legal document therefore all measurements and information provided is subject to survey. No permission is given to use or alter this Floor Plan without the consent of Pure Design Concepts. The overall presentation style, layout, imagery, fonts, background, colours and terminology has been originally created by PDC and is subject to strict copyright. No ownership is taken of building design. Find out more at puredesignconcepts.com.au

