

6 Matong Street Gordon, NSW



Offered For The First Time In 60 years - Pedigree East Side Locale

Substantial Family Home Ready For A New Chapter.

Occupying a generous 1,009.2sqm (approx.) on Gordon's prestigious east side, this original solid brick home presents an exceptional blank canvas opportunity in one of the area's most sought-after neighbourhoods. The home offers grand scope to personalise for dream family living and in a serene location with close proximity to Gordon Centre shops, rail and excellent local schools.



Daniel Patterson

0421 882 692



Steven Kourdis

0402 555 675

6 Matong Street
Gordon



SITE PLAN

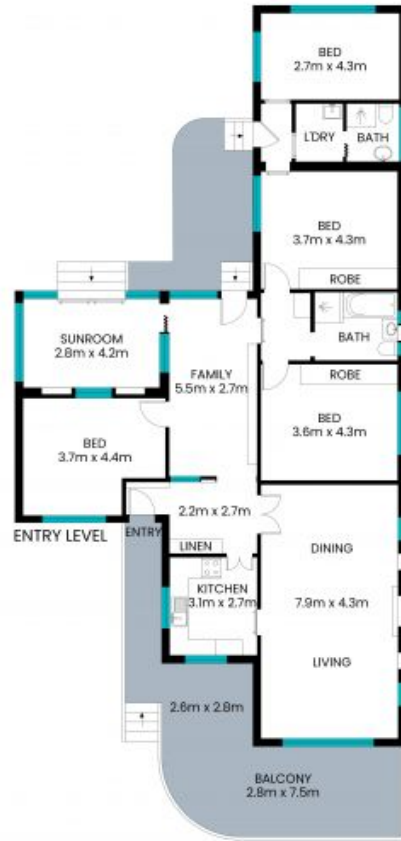

STONE

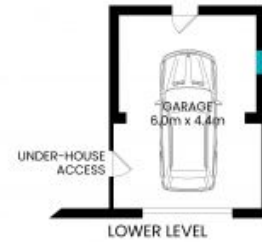

Internal area: 159m²
External area: 49m²
Garage area: 27m²
Total area: 235m²

The site plan and floor plan are not to scale; measurements are indicative and in meters. Bushes and trees are placed for illustration purposes. Plans should not be relied on. Interested parties should make and rely on their own enquiries. All other information provided has been collected from reliable sources but cannot be guaranteed for accuracy.