



302/51-54 The Esplanade Ettalong Beach, NSW 1  1

### Holiday or invest in a Premium Position

Looking for a place in one of the Central Coast's best locations without the big price tag? This north-facing Level 3 unit is set directly across from the Ettalong Beach waterfront and right in the heart of it all cafes, restaurants, shops, the cinema, local markets and the Palm Beach Ferry are all just moments away.

**Price:** \$420,000  
**Council Rates:** \$1,212.59/year (approx)  
**Water Rates:** \$1,099.08/year (approx)  
**Strata Rates:** \$1,139.60 p/q



**Christel Renton**

0417 208 314



**Ella Maskill**

0474 958 499

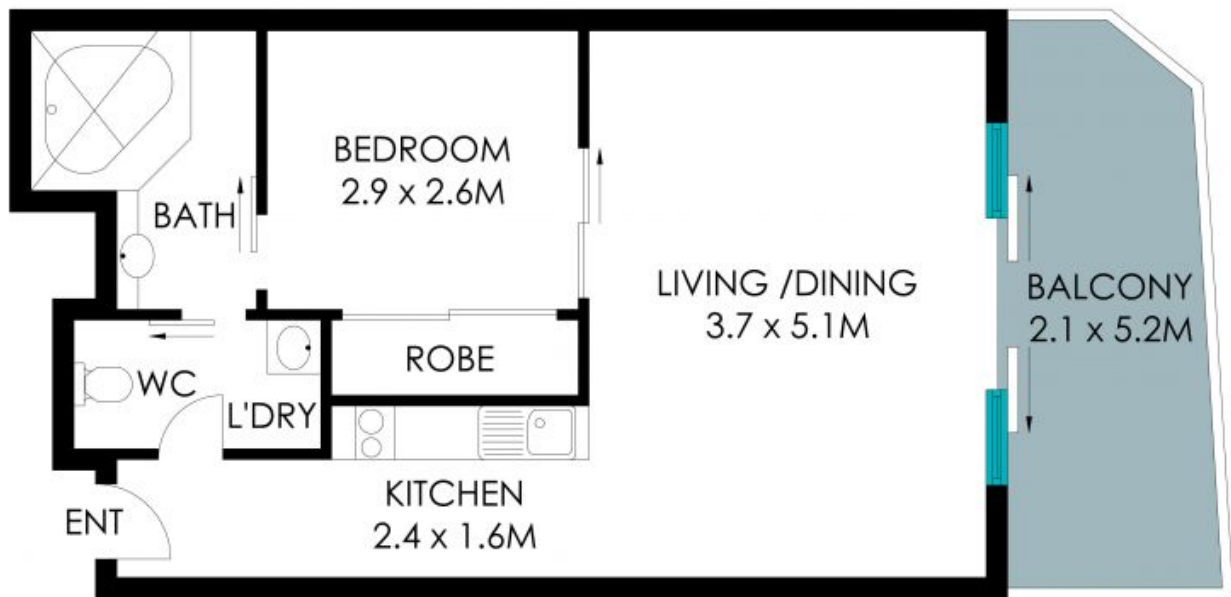

Total Living Area: 52 sqm



The site plan and floor plan are not to scale; measurements are indicative and in metres. Bushes and trees are placed for illustration purposes. Plans should not be relied on. Interested parties should make and rely on their own enquiries. All other information provided has been collected from reliable sources but cannot be guaranteed for accuracy.