



723/22 Central Avenue Manly, NSW



### Ultra-chic pad with ocean views in the village

From its soaring seventh floor vantage point in the resort-like Manly National building, this exceptionally bright and modern apartment reveals dazzling views over Manly Village to the ocean and Shelly Beach. Cosmopolitan eateries and the buzz of the Corso are literally metres from your doorstep, and world-famous Manly Beach and Manly Wharf are only a few minutes stroll away.

**Price:** \$870,000



**Sam Bursill**

0449 969 452



**Candice Cattell**

0417 311 777

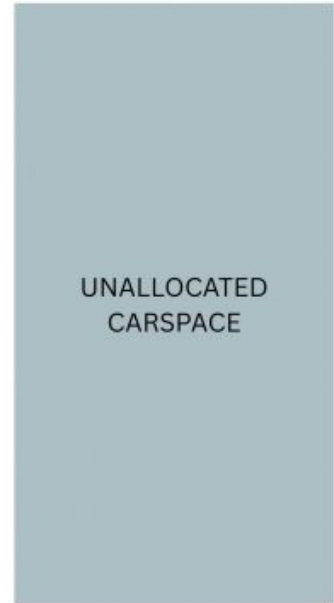
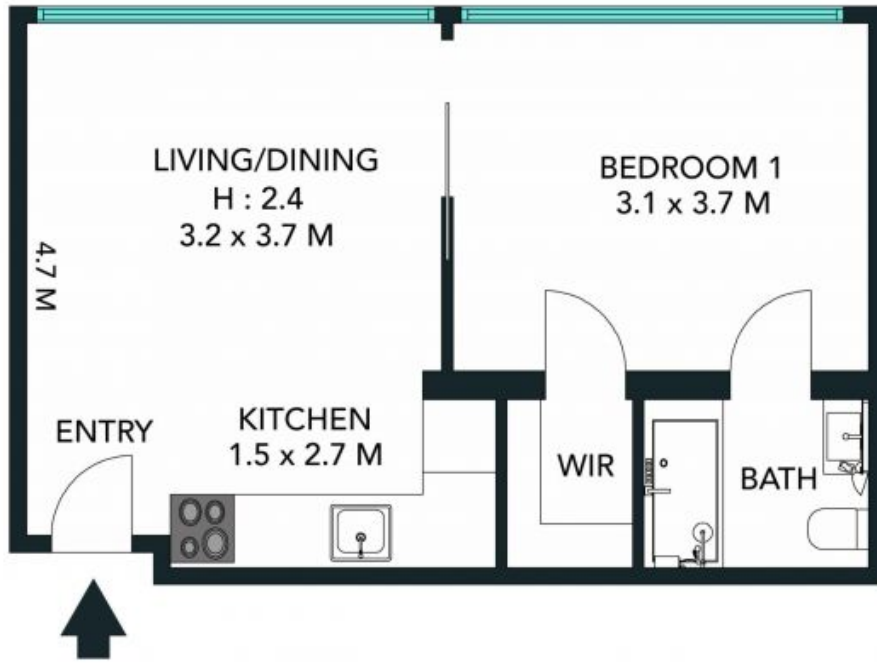

The floor plan is not to scale; measurements are indicative and in metres. Exterior elements are not in position. Plans should not be relied on. Interested parties should make and rely on their own enquiries.

