



6 Ashton Drive Heddon Greta, NSW



### Modern Single-Level Living with Style and Comfort

Perfectly suited to first home buyers, downsizers or savvy investors, this neat and tidy brick-and-tile residence offers comfortable, low-maintenance living in a practical single-level design. The home features four well-proportioned bedrooms, including a principal suite complete with built-in robe and private ensuite. The remaining three bedrooms are all generously sized and fitted with built-in robes and ceiling fans, providing comfortable accommodation for the whole family.

**Price:** \$799,000



**Renee Bean-Wyper**

0403 325 076



**Jorja Pauling**

0435 930 665

6 Ashton Drive  
Heddon Greta

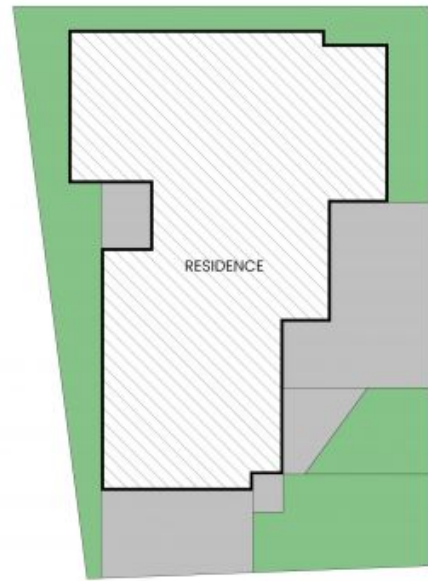

SITE PLAN



The site plan and floor plan are not to scale; measurements are indicative and in metres. Bushes and trees are placed for illustration purposes. Plans should not be relied on. Interested parties should make and rely on their own enquiries. All other information provided has been collected from reliable sources but cannot be guaranteed for accuracy.