



2/5-7 Hoddle Avenue Bradbury, NSW

2 1 1

Convenient investment opportunity

This neat and tidy two-bedroom apartment offers a great opportunity for investors looking for a low-maintenance property in a highly convenient location. Currently leased until July 2026 & paying \$430 P/W, it provides secure rental income from day one.

Price: \$395,000



Gary Luke
0418 451 105



Kaitlin Hall
0404 529 516

STONE

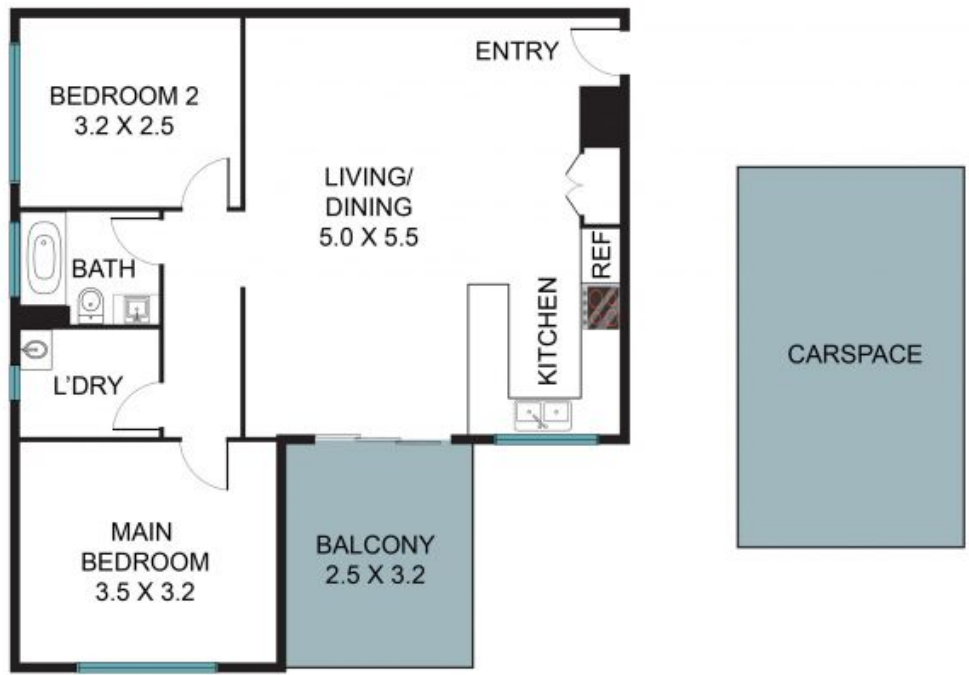

2/5-7 Hoddle Ave, Bradbury NSW 2560



The floor plan is not to scale, measurements are in metres. Exterior elements are not in position.
Plans should not be relied on. Interested parties should make and rely on their own enquiries.
All other information provided has been collected from reliable sources but cannot be guaranteed for accuracy.