



4 Bambara Crescent Beecroft, NSW

4 2 2

Tranquil family haven with studio flexibility & beautiful gardens

This charming single-level family home enjoys a peaceful, leafy setting. Filled with cottage-style character, it features expansive living spaces surrounded by stunning private gardens that offer lush greenery in every direction. A versatile, separately accessed studio provides the perfect option for a fourth bedroom or home office. Ideally located, the property is approx 2.7km from local bus services, North Carlingford village shops, and highly sought-after schools.

Price: \$1,250 per week | Lawn Included
Available Date: 06/05/2026



Daniel Yao

8893 2245

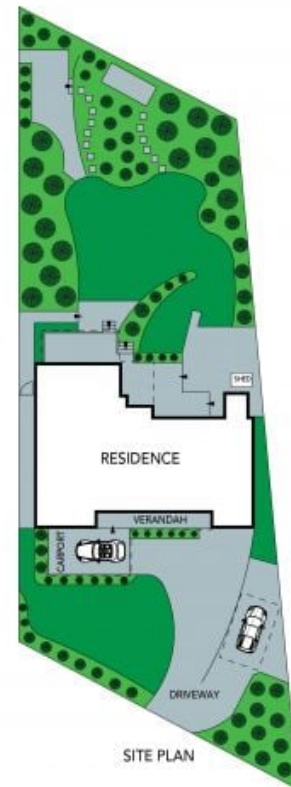

The floor plan is not to scale; measurements are indicative and in metres. Exterior elements are not in position. Plans should not be relied on. Interested parties should make and rely on their own enquiries.

4 Bambara Crescent, Beecroft

Internal Area approx - 160 sqm
 External Area approx - 70 sqm
 Land Area approx - 942.2 sqm

