



43 Woodcutters Grove Epping, VIC



Space, Style & Functionality in One Smart Package

Welcome to 43 Woodcutters Grove ? a well-designed and modern townhouse offering space, flexibility, and low-maintenance living in a highly convenient Epping location. Perfectly suited for families or professionals, this home delivers a smart layout with multiple living zones and a dedicated study for those working from home.

Price: \$490 pw
Available Date: 11/05/2026



Chloe Dwyer-Fraser

0466 669 118



Fadzi Mutusva

0455 332 296

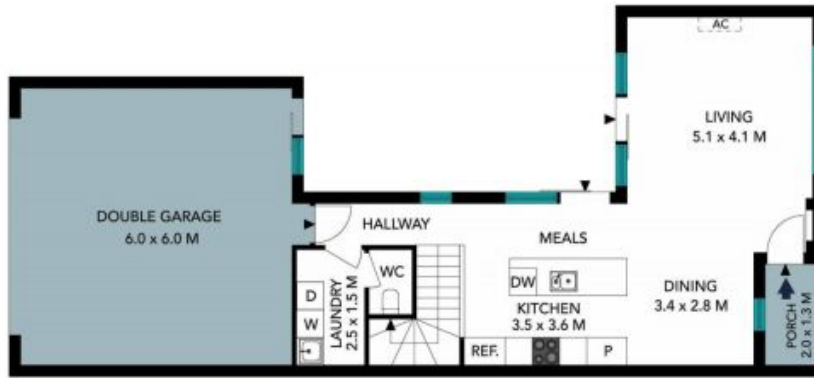

GROUND LEVEL

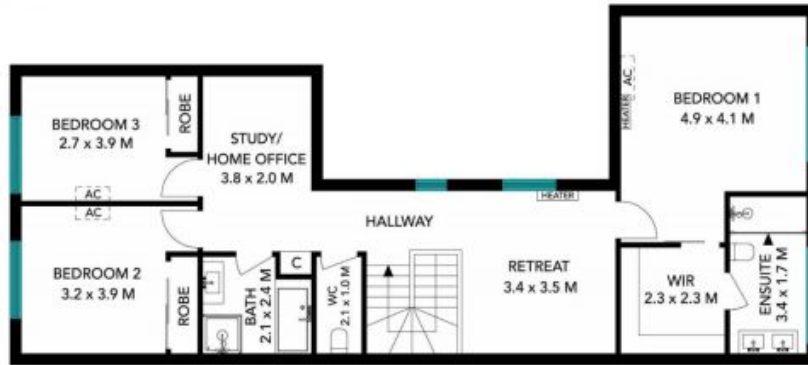

LEVEL 1

THE FLOOR PLAN IS NOT TO SCALE; MEASUREMENTS ARE INDICATIVE AND IN METRES. EXTERIOR ELEMENTS ARE NOT IN POSITION. PLANS SHOULD NOT BE RELIED ON. INTERESTED PARTIES SHOULD MAKE AND RELY ON THEIR OWN ENQUIRIES.

Produced by DIAKF



GROUND LEVEL



LEVEL 1

THE FLOOR PLAN IS NOT TO SCALE, MEASUREMENTS ARE INDICATIVE AND IN METRES. ALL FEATURES INCLUDED IN THIS 3D PLAN ARE FOR INSPIRATION PURPOSES ONLY. THIS IS NOT AN EXACT REPLICA OF THE PROPERTY OR THE POSITION OF EXTERIOR ELEMENTS. PLANS SHOULD NOT BE RELIED ON. INTERESTED PARTIES SHOULD MAKE AND RELY ON THEIR OWN ENQUIRIES. Produced by **DIAKI**