



786 Limeburners Creek Road Clarence Town, NSW



Rural Grandeur on 1.52ha

Brimming with character, this Georgian-style residence delivers timeless elegance across two expansive levels, set on a beautifully private 1.52ha rural holding framed by established gums and natural surrounds. A sanctuary of space and serenity, it offers refined country living with seamless indoor?outdoor flow and multiple lifestyle zones.

Inspect: Saturday, 16th May 2026 11:45 - 12:15

Price: PREVIEW



David Tanchevski

02 4089 1111



Courtney Matheson

0400 768 103

786 Limeburners Creek Road
Clarence Town

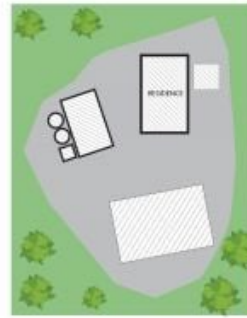

SITE MAP



GROUND FLOOR



1ST FLOOR

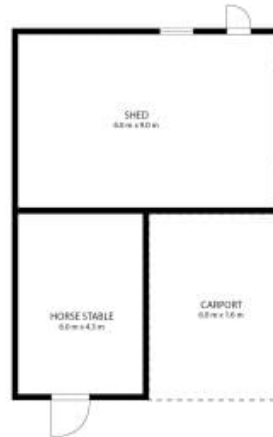

The site plan and floor plan are not to scale; measurements are indicative and in metres. Bushes and trees are placed for illustration purposes. Plans should not be relied on. Interested parties should make and rely on their own enquiries. All other information provided has been collected from reliable sources but cannot be guaranteed for accuracy.