

509/30 Shepherd Street Liverpool, NSW



Riverside apartment promises modern convenience

Embracing gorgeous river outlooks from a chic complex, this low maintenance apartment offers a truly spectacular modern lifestyle. It showcases sleek finishes throughout light-filled interiors, perfect for buyers seeking an exquisitely crafted haven. The property is in a convenient address, just a 120 metre stroll to the Paper Mill dining precinct while 1.1km from the vibrant heart of Liverpool and station.

Inspect: Saturday, 16th May 2026 12:15 - 12:45
Saturday, 23rd May 2026 11:45 - 12:15

Price: \$450,000 - \$475,000



Glen Craigie

0401 529 930

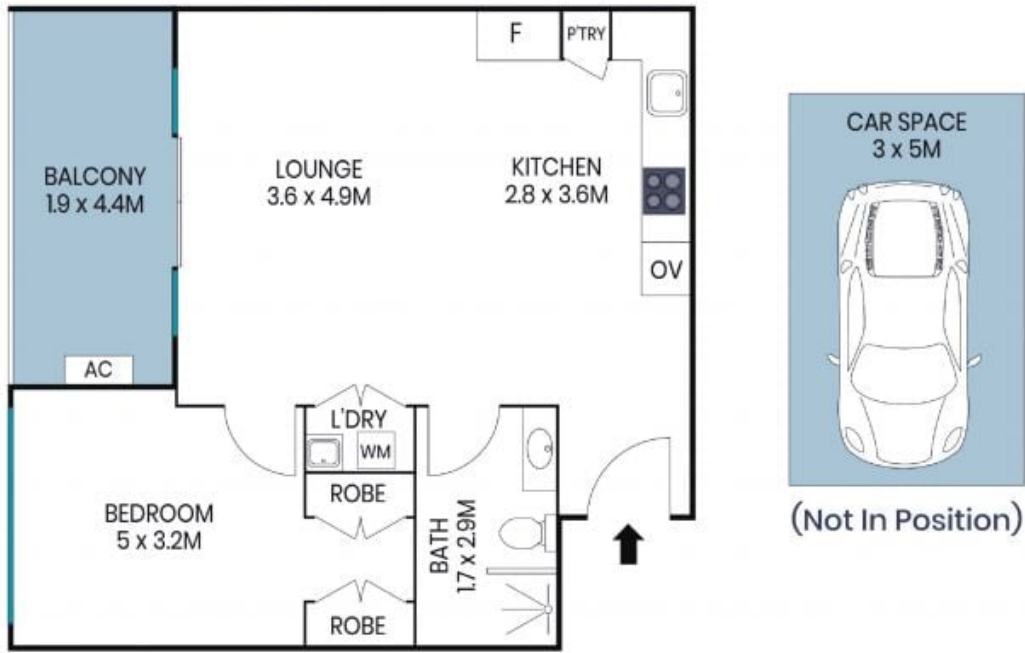

Level Five



The site plan and floor plan are not to scale; measurements are indicative and in metres. Bushes and trees are placed for illustration purposes. Plans should not be relied on. Interested parties should make and rely on their own enquiries. All other information provided has been collected from reliable sources but cannot be guaranteed for accuracy.