

1406/30 Shepherd Street Liverpool, NSW

2 2 1

Stylish modern apartment with sweeping city views

Capturing breathtaking north west panoramic views of the Sydney skyline from a prized fourteenth floor position in the prestigious Bindery development at The Paper Mill precinct, this contemporary apartment delivers style, comfort and convenience. Enjoying a vibrant lifestyle just footsteps from popular dining, riverside parklands and walking trails, while remaining close to Liverpool CBD, transport and shopping hubs.

Inspect: Saturday, 23rd May 2026 11:15 - 11:45

Price: \$630,000 - \$670,000



Glen Craigie

0401 529 930



Frank Bartolone

0411 477 758

1406/30 Shepherd Street
Liverpool

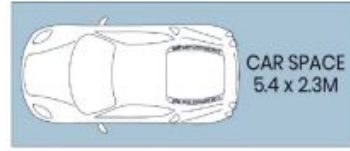
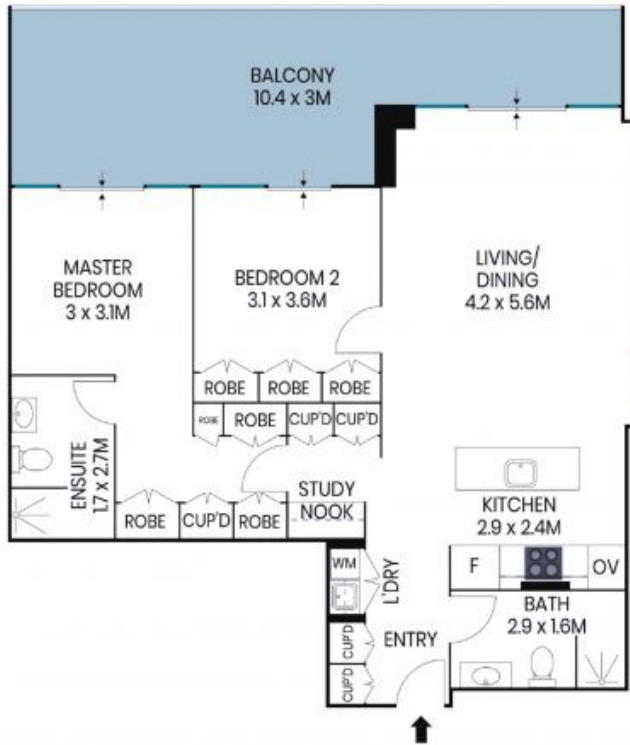

Basement Level One



The site plan and floor plan are not to scale; measurements are indicative and in metres. Bushes and trees are placed for illustration purposes. Plans should not be relied on. Interested parties should make and rely on their own enquiries. All other information provided has been collected from reliable sources but cannot be guaranteed for accuracy.